

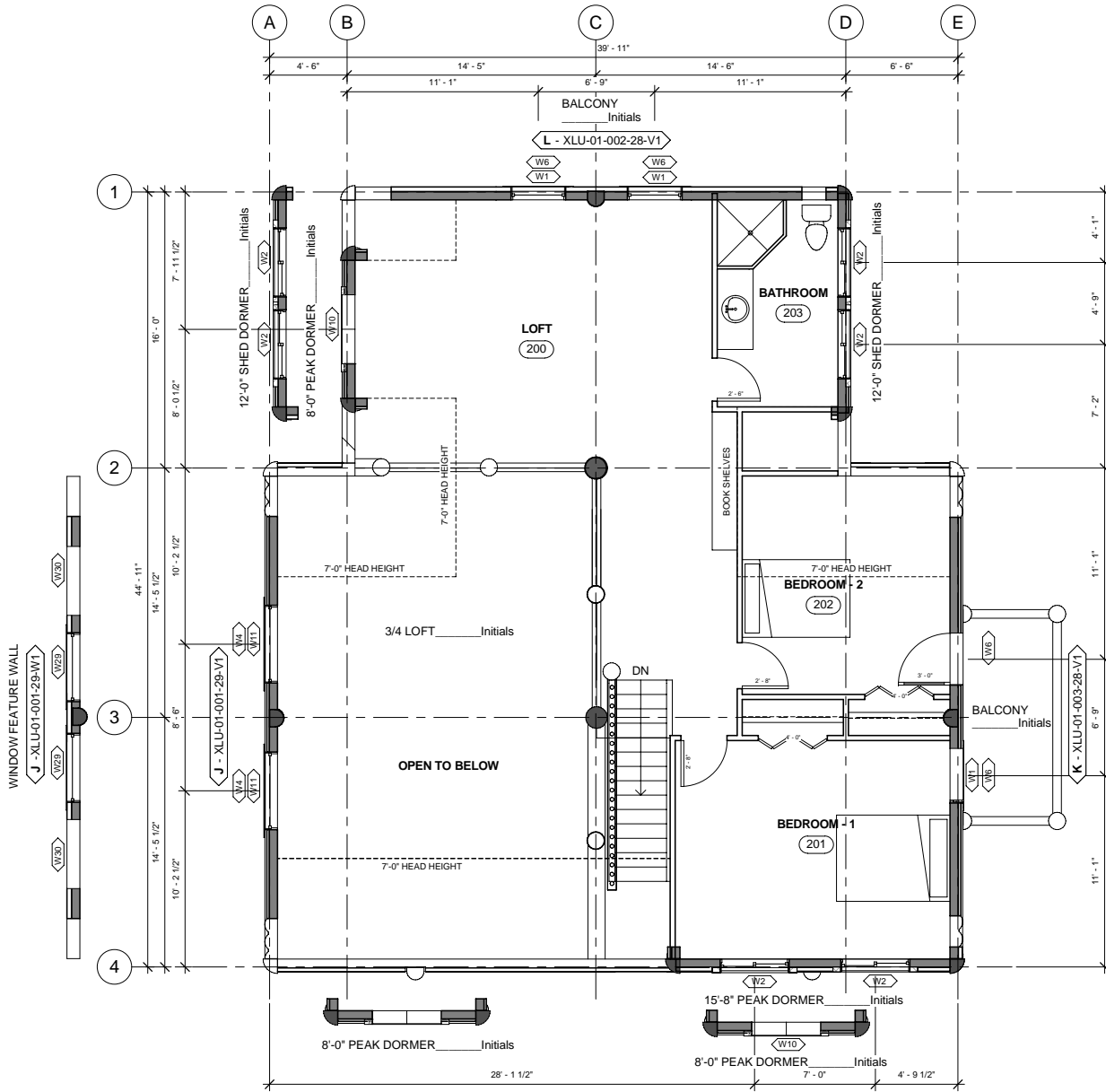

 24 MAR 2006  
**EAGLE RIVER LOFTED 1**  
 SCALE: 1" = 10'-0"

707 SQ FT  
 1016 SQ FT TOTAL  
 OPTIONS SHOWN  
 BALCONY

OPTIONS AVAILABLE  
 DORMER OPTIONS SHOWN  
 WINDOW FEATURE WALL





 24 MAR 2006  
**EAGLE RIVER LOFTED 2**  
 SCALE: 1" = 10'-0"

**772 SQ FT**  
**1016 SQ FT TOTAL**  
**OPTIONS SHOWN**  
 BALCONY  
 DORMERS SHOWN

**OPTIONS AVAILABLE**  
 DORMER OPTIONS SHOWN  
 WINDOW FEATURE WALL

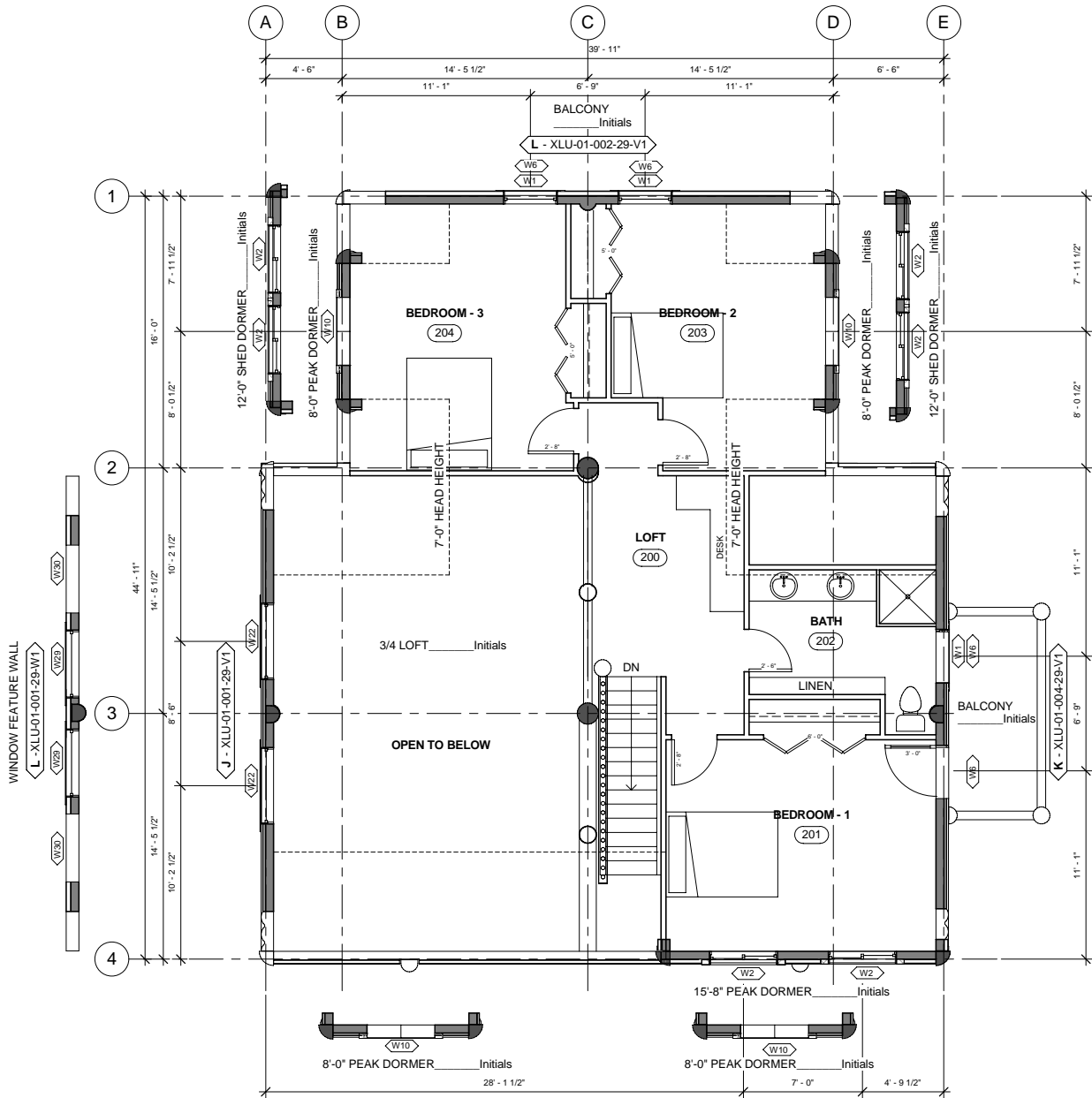



24 MAR 2006  
 WHISPER CREEK LOG HOMES  
**EAGLE RIVER LOFTED 4**  
 SCALE: 1" = 10'-0"

762 SQ FT  
 1016 SQ FT TOTAL  
 OPTIONS SHOWN  
 BALCONY  
 DORMERS SHOWN  
 OPTIONS AVAILABLE  
 DORMER OPTIONS SHOWN  
 WINDOW FEATURE WALL

